



Important!

En cas de probleme lors de l' installation,
contactez un eletricien .

Coupez le courant avant de commencer
l' installation.

Importante!

Se hai problemi con l' installazione
elettri-ca,contatta un elettricista qualificato.

Stacca la corrente prima di iniziare
l' in-stallazione

Wichtig!

Wenn Sie Probleme bezüglich der
elektrischen Installation haben,wenden
Siesich an einen Elektriker.Schalten Sie
vor jeder Installation die Stromzufuhr ad.

Important!

If you have any problems regarding the
electrical installation,contact an electrician
Always shut off power to the circuit
before starting installation works

注意！

若有任何安裝上的問題，請諮詢專業的電氣技師。

在開始安裝工作前，記得把電路 的電源關閉

重要信息！

如遇任何安装方面的问题，须向专业电工人
员咨询求助。安装之前，务必关闭电源总闸。



KOTORI P-LIGHT

instruction manual

KPL-2230

KPL-3920

KPL-5320

KPL-7136

DC pendant

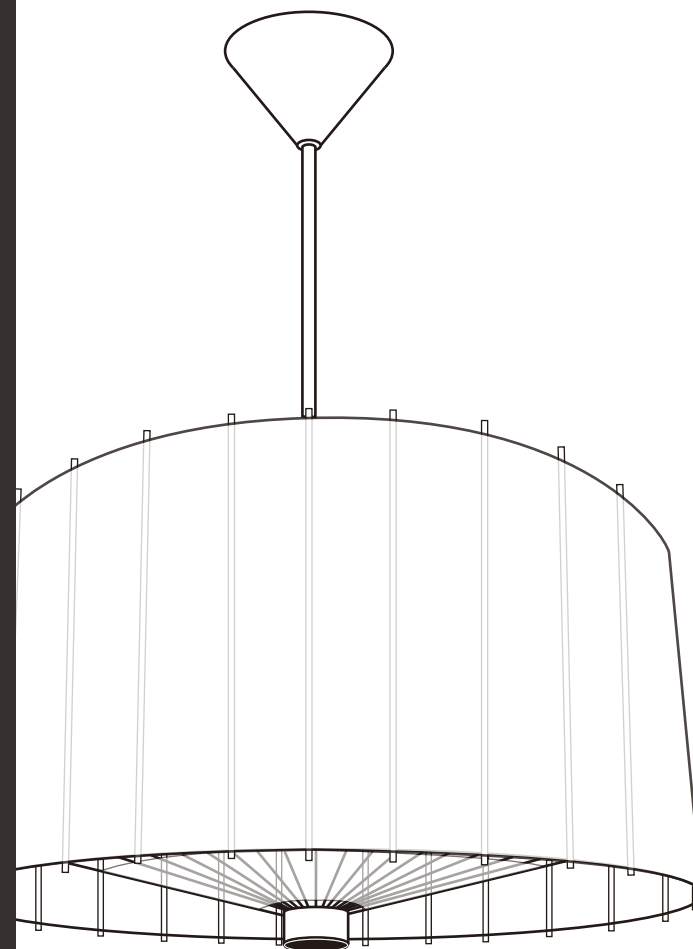

HIYOSHIYA CO., Ltd.

info@wagasa.com

Tel: +81 (0)75 441 6644

Fax: +81 (0)75 441 6645

Checking the supplied items

KOTORI LAMPSHADE

- ☐ **KPL-2230**
Φ 220mm × H300mm
- ☐ **KPL-3920**
Φ 388mm × H205mm
- ☐ **KPL-5120**
Φ 530mm × H280mm
- ☐ **KPL-7136**
Φ 708mm × H355mm
- ☐ **DC pendant**
Φ 388mm × H205mm

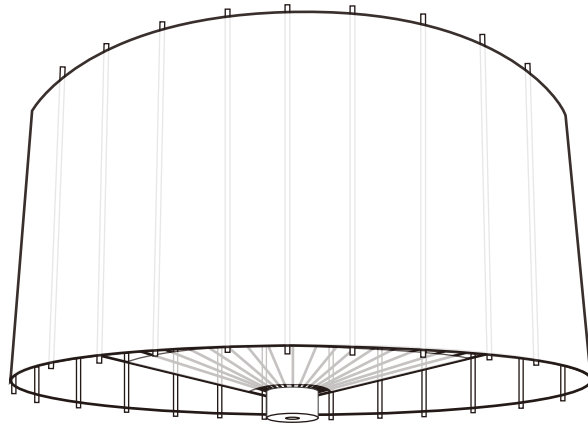

※Lighting bulb is not included.

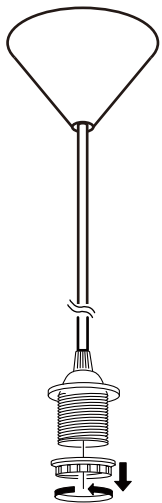

(1)

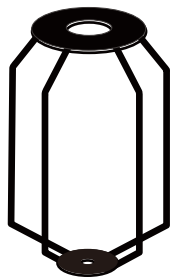

(1)



(1)



(1)



(1)



(1)

1

Please pull to the both side gently!!

Do not pull too much.

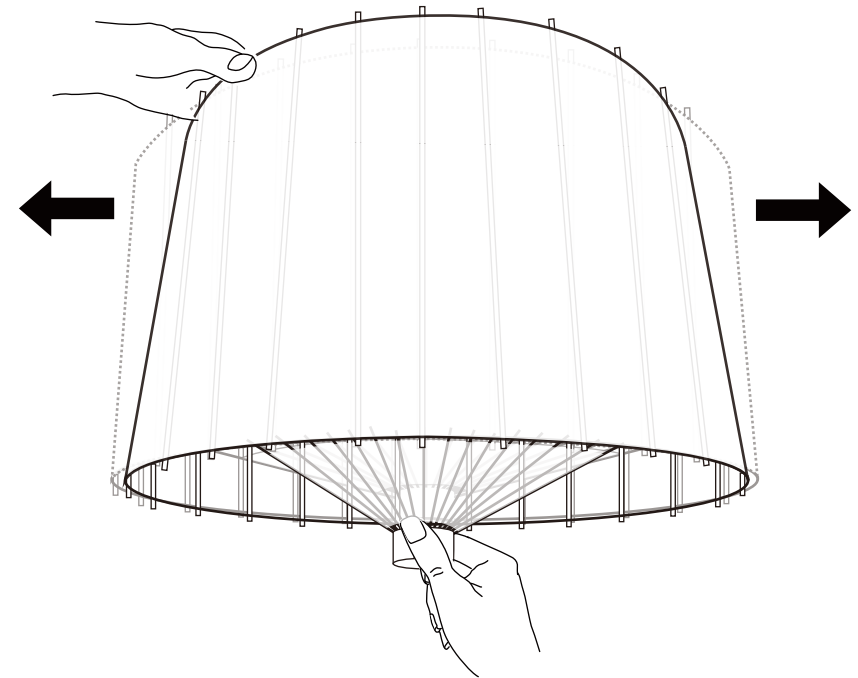

NOTICE

The lampshade is close like an umbrella in the box.
If it doesn't open enough when you open the shade,
please pull to the both side gently.

Do not pull too much.

The products are handmade and made by natural, therefore shapes and measurements may differ slightly from the specifications and drawings.

2

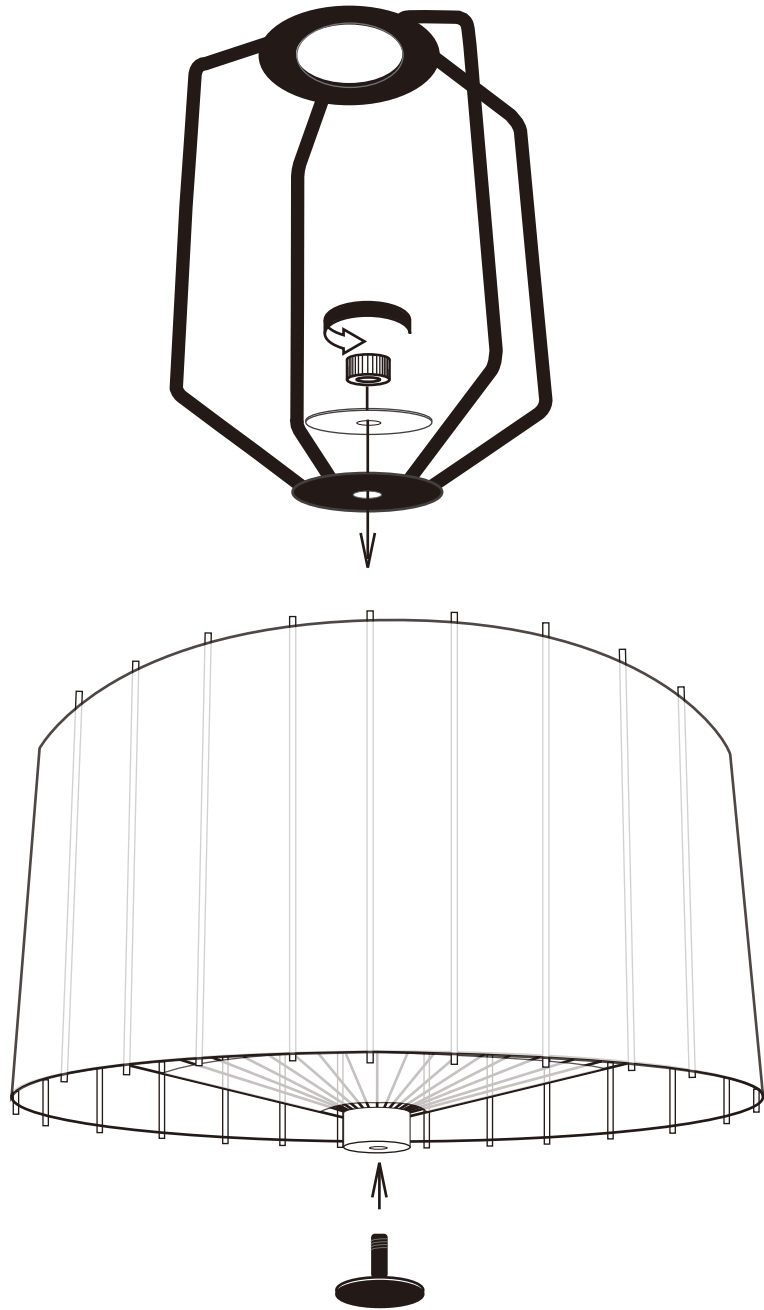

3

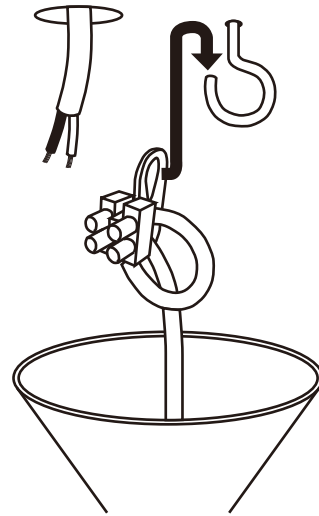

4

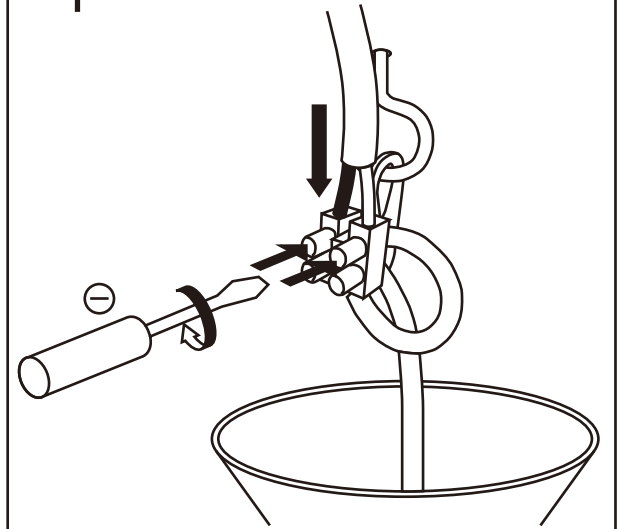

5

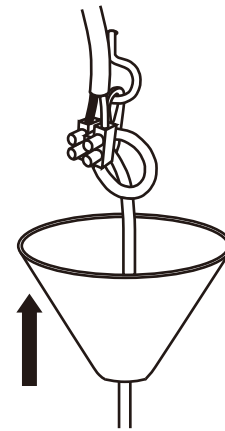

6

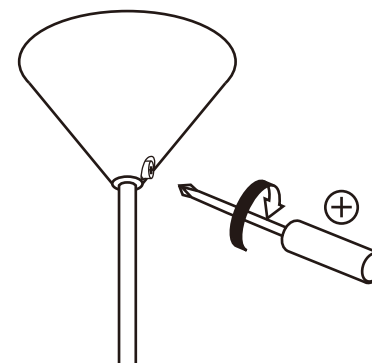

7

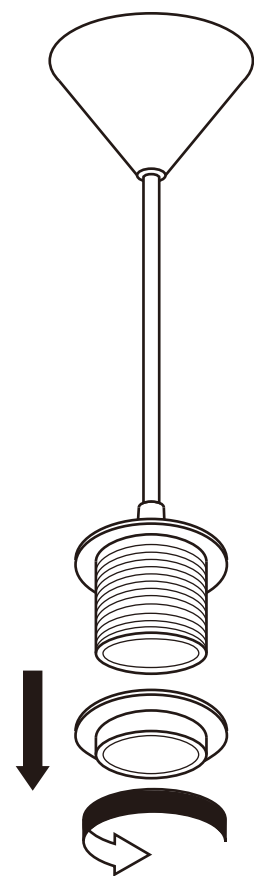

8

Inclination adjustment

- ① Loose the A parts.
- ② Slide B&C parts for stabilize the shade's horizontal level.

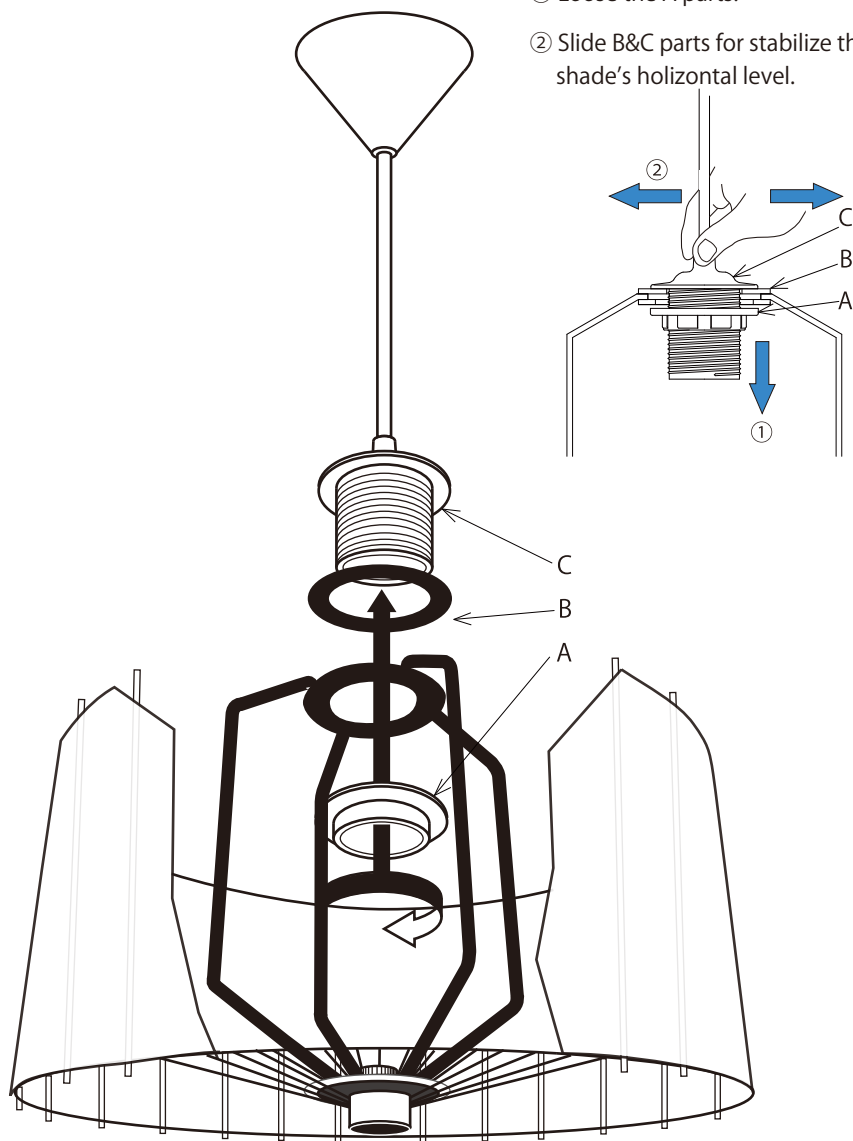

Lamp E27 Maximum 60W



9

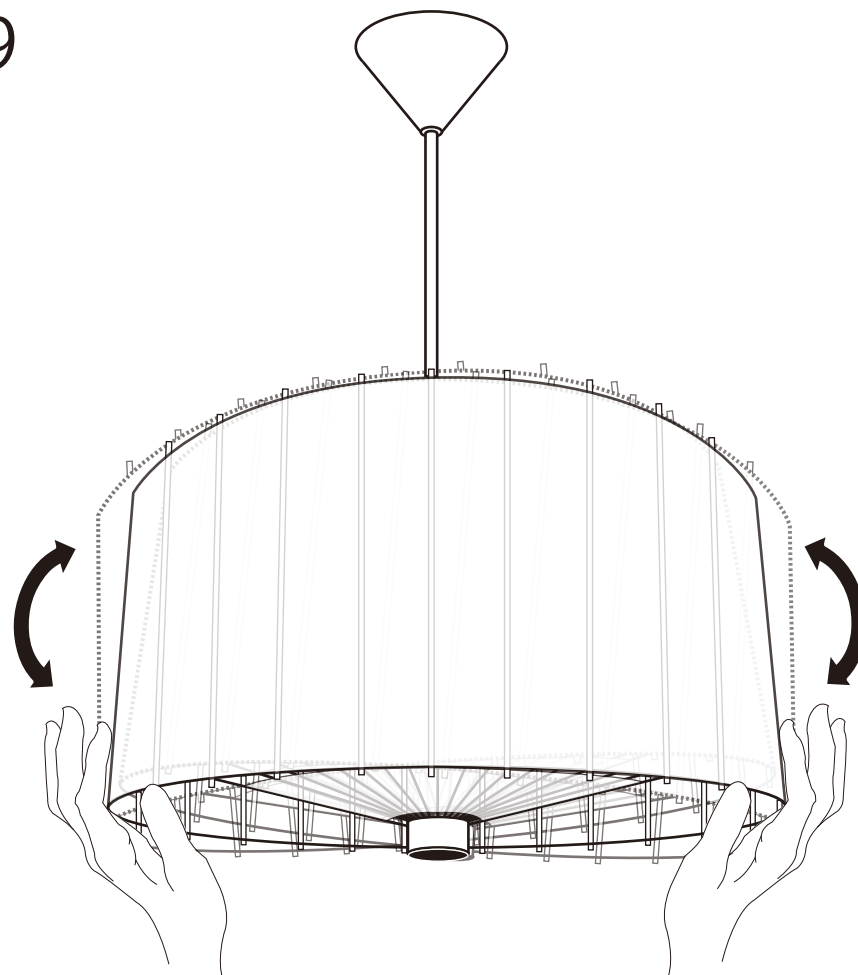

Arrangement of horizontal position

Please lean the shade by hand and hold or shake, move some moment and make the shade keep horizontal position.

Please do it gently.

The product is designed by One-point suspension sysytem.
It can not be keep 100% perefect horizontal level sometime.